

COOKING
SURFACE PRIME

MOKA
BY COOKING SURFACE



www.cookingsurface.com

MOKA

by COOKING SURFACE

Content:

1 x Coffee maker

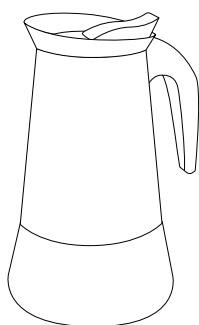

- Height: 200mm
- Base diameter: 115mm
- Capacity: 350ml (7 cups)
- Ergonomic handle
- Safety valve
- Removable filter

Introduction:

The MOKA by Cooking Surface Italian coffee maker for 7 cups has the highest quality, please familiarize yourself with the product before using it for the first time, for this, carefully consult the operating instructions and the safety advice detailed below.

Use the product only according to the instructions and only for the indicated field of application. Keep these instructions in a safe place.

If you transfer the product to someone else, be sure to pass all your documentation on as well.

Safety instructions:

WARNING, DANGER AND RISK OF ACCIDENT FOR CHILDREN!

- Never leave children unsupervised with the packaging material due to the risk of suffocation.
- Keep children away from the product.
- WARNING: Never leave children unsupervised near hot cooking equipment.
- WEAR SAFETY GLOVES! The product becomes very hot during cooking, as a tip use potholders or gloves.
- Never heat utensils at maximum power if they previously contain fat, as there is a risk of overheating. If this happens, turn off your induction hob immediately.
- The coffee maker should never be left unattended or without liquid inside.

- In the event of a fire involving any of the contents, do not extinguish burning grease with water, smother the flames with a blanket, or use a fire extinguisher.
- Do not rinse the product with cold water.
- Never heat the product if there is no water in the lower base.
- Heat the product at a moderate temperature, using low or medium powers.
- Do not slide or drag the product across the porcelain, it is preferable to lift or lift it with each movement so as not to damage the material.
- Do not overheat the product. If an overheating of the appliance arises, ventilate the area well.
- High temperatures can discolor the exterior of the product.

Recommendation use:

- The product is only suitable for private or domestic use, not for professional purposes.
- In your Cooking Surface hidden induction system, always use power levels below level 6 to avoid electromagnetic incompatibilities as well as excessive temperature on the porcelain surface.
- If desired, set the timer on your Cooking Surface to prevent the coffeemaker from continuing to heat after all the coffee has been brewed.
- If the coffee maker continues to heat up without water, it could cause a thermal shock to the porcelain surface and damage the countertop.
- If you have SVIF-CK3.0 with 9 levels, our recommendation is to place the coffee maker on medium heat (1800W) with a power level of 6 and a timing of 3 minutes.

Before its first use:

- When using the coffee maker for the first time, unscrew the top, remove the funnel or filter, and check that the filter device and rubber ring under the upper pot are installed and in good condition. Separate and clean all parts with hot water and reinstall. It is also advisable to discard the first coffee that is made with the Italian coffee maker.
- Specific use for Cooking Surface induction hob.
- Induction cooking may result in a technical hum, this sound does not indicate a fault with your cooktop or product. Does not affect cooking performance.

Operating instructions:

- Fill the base or tank chamber of the coffee maker with water, pay special attention not to exceed the height of the safety valve. **See image 2.**
- Next, incorporate the ground coffee into the funnel or filter. The grind should be of a medium consistency, neither too fine nor too coarse. Do not overfill the container or press it.
- Level the excess coffee and clean any rests that may have remained around the edges. Place the funnel in the base with water from the coffee maker and incorporate the upper part, screwing it on.
- Place the coffee pot on the cooking zone over medium-low heat.
- Once the coffee has come out (approximately 3 minutes), turn off the cooking zone so that it does not continue to heat the container and remove your coffee maker.
- Serve the coffee immediately. Italian coffee is quite strong, so many people prefer to dilute it with hot water or milk.

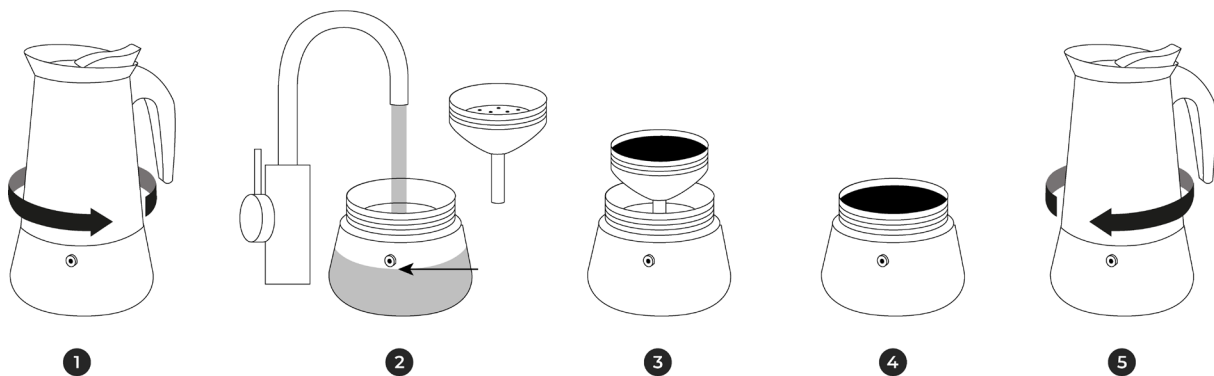

Cleaning and care:

- Allow the product to cool down properly after use before cleaning to maintain the metal properties of the product.
- Never use scourers or abrasive products for cleaning.
- It is essential to clean the product after each use with hot water and a sponge.
- Over time, the minerals in the water can cause stains or discoloration on the product. You can get rid of these spots by rubbing half a lemon on them. For stubborn stains, they can be cleaned with a mixture of nine parts water to one-part vinegar.

Provision:

The packaging is made entirely of recyclable materials, it can be disposed of in the local recycling facilities. Contact your local garbage disposal authority for more details on how to dispose of your used packaging.

Warranty:

The product has been manufactured with strict quality guidelines and meticulously examined before delivery. The warranty for this product is 2 years from the date of purchase, if the products show a defect in material or manufacturing make use of your warranty before use your product.

In order to need legal communication with Cooking Surface, you should contact:

Arbe Stolanic S.L.

Calle Gregal, 27 Pol. Ind. Los Vientos

46119 Náquera (Valencia) Spain

COOKING
SURFACE PRIME



info@cookingsurface.com

www.cookingsurface.com